

Fingerprint drawer/ cabinet lock

1,Product View



IF915



IF919



IF920



IF921



IF922



IF928



IF933



IF978



IF986

2,Product Features:

- 1,Advanced Biometric technology for better response and sensitivity
- 2,Multiple access for option: Fingerprint, pincode, card.
- 3,Zinc alloy panel with stainless steel latch, strong and durable
- 4,Motorized lock system, locker locks automatically;
- 5,Anti-thief Alarm(ATA) Buzzer alarms for 60s when latch be pressed or picked.
- 6,Illegal Key Alarm Buzzer alarms for 60s after 4 attempts with an illegal IC card.
- 7,Low-voltage Alarm Buzzer alarms when unlocking under the voltage DC4.2+/-0.2,notifies to replace new batteries.
- 8,External Power Backup USB port is for emergent power supply when internal batteries in low voltage.

3,Technical Paramet

Model No	IF915/919	IF920/921	IF922/933	IF928	IF933	IF978
Access	Fingerprint, Code,Card	Fingerprint, pincode	Fingerprint, pincode	Fingerprint	Fingerprint	Fingerprint, Temic Card
Fingerprint	20 pcs	20 pcs	20 pcs	20 pcs	20 pcs	40 pcs
password	1-10 digi	1-10 digi	1-10 digi	No	No	No
Static Current	≤25uA	≤25uA	≤25uA	≤25uA	≤25uA	≤20uA
Dynamic Current	≤200mA	≤200mA	≤200mA	≤200mA	≤200mA	≤200mA
Working Temperature	0℃~55℃	0℃~55℃	0℃~55℃	0℃~55℃	0℃~55℃	15℃~55℃
Working Humidity	RH20%~80%	RH20%~80%	RH20%~80%	RH20%~80%	RH20%~80%	RH20%~95%
Power supplier	4.5V/3AA	4.5V/3AA	4.5V/3AA	4.5V/3AA	4.5V/3AA	4.5V/3AA
Low Voltage	3.6V+/-0.2V	3.6V+/-0.2V	3.6V+/-0.2V	3.6V+/-0.2V	3.6V+/-0.2V	3.7V+/-0.2V
USB Emergency	Yes	Yes	Yes	Yes	Yes	Yes
Life Time	>10,000	>10,000	>10,000	>10,000	>10,000	>10,000
Door Thicknes	>9mm	>3mm	>3mm	>3mm	>3mm	>11.5mm

4,Details and Dimensions of fingerprint drawer Lock

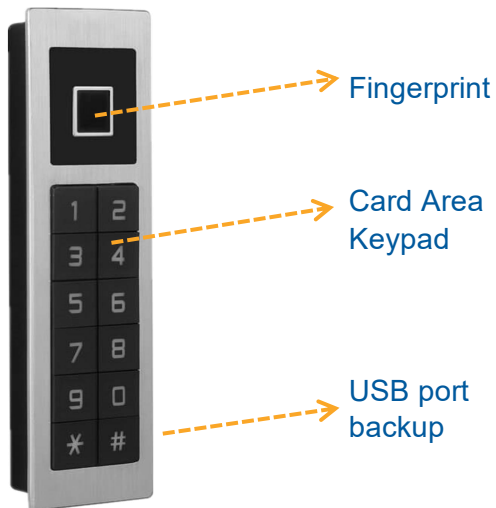

IF915

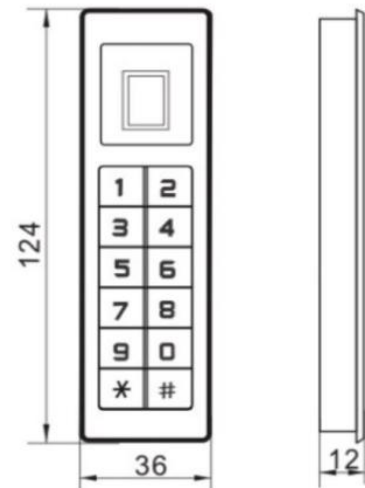

IF915 Dimension

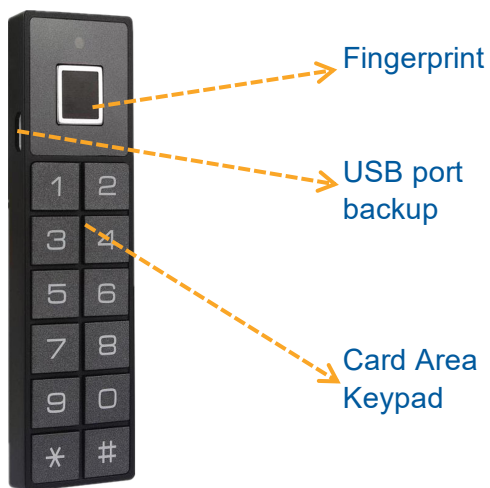

IF919

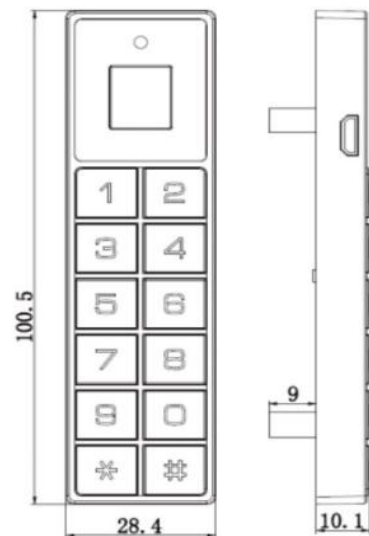

IF919 Dimension



IF920

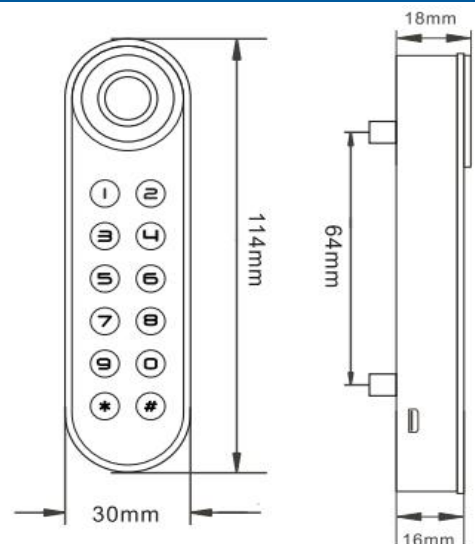

IF920 Dimension

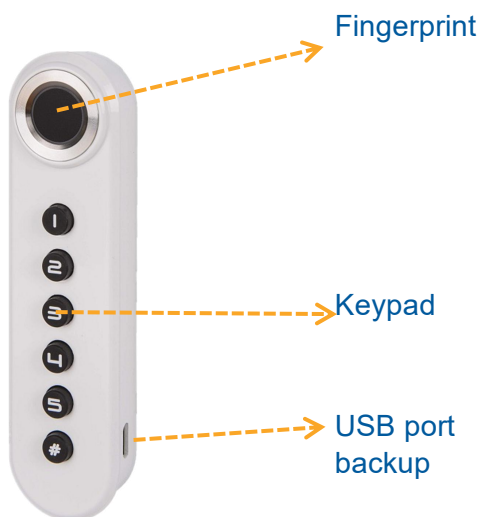

IF921

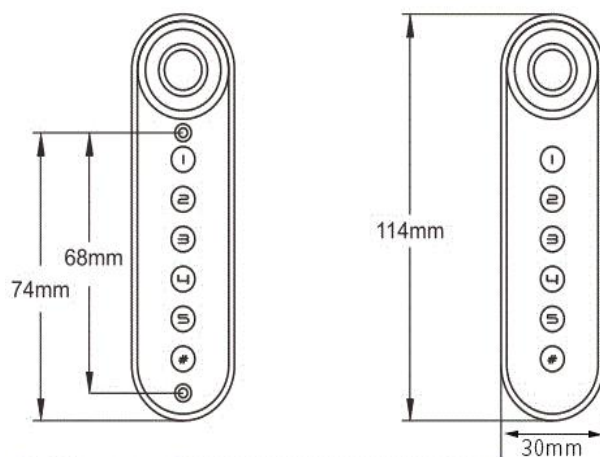

IF921 Dimension

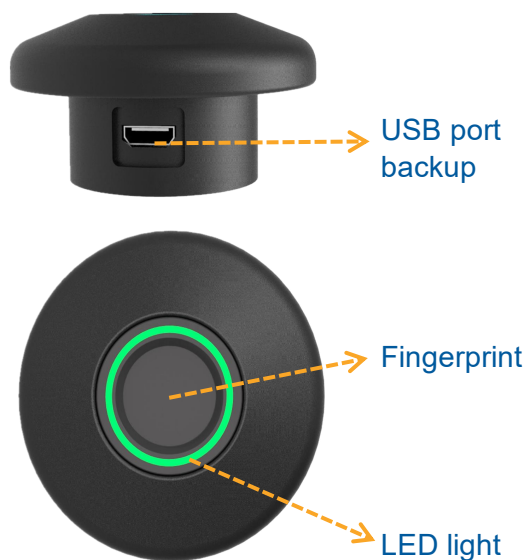

IF922

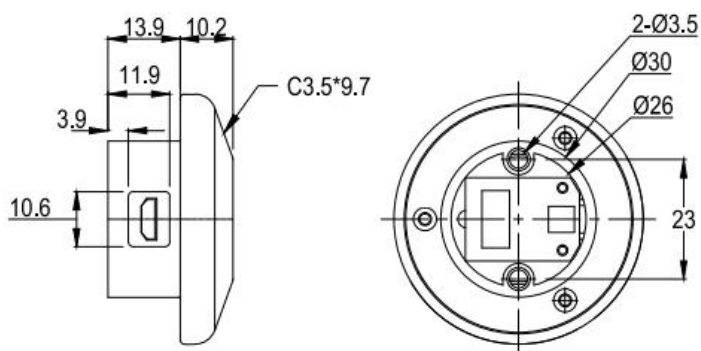

IF922 Dimension

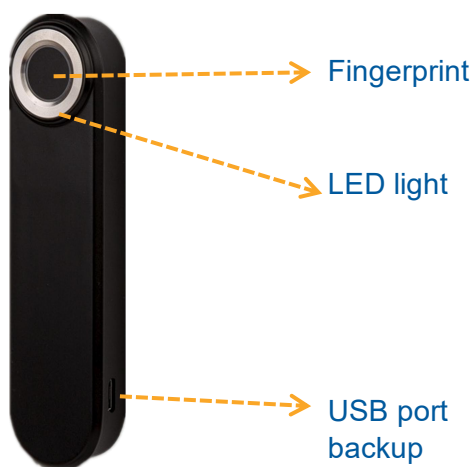

IF928

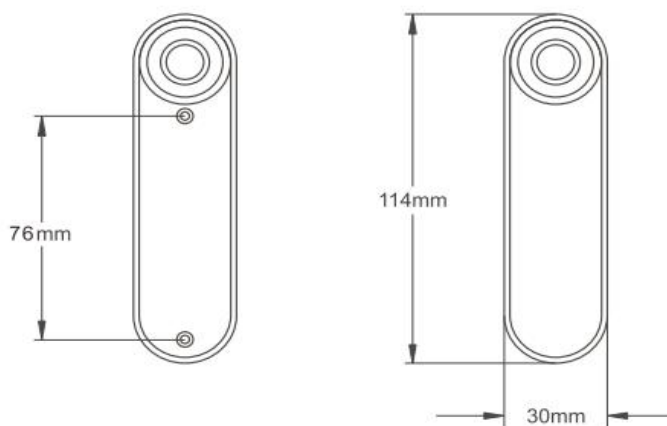

IF928 Dimension

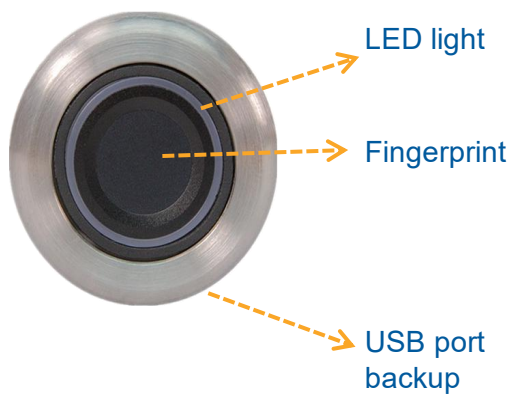

IF933

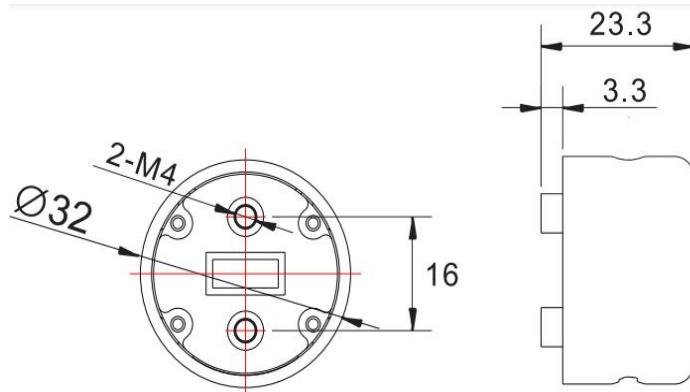

IF933 Dimension



IF978

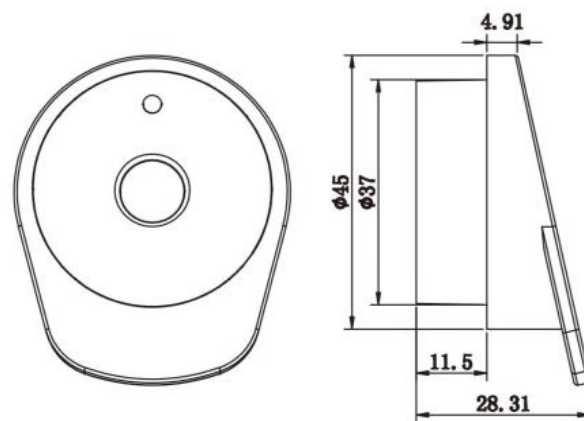

IF978 Dimension



IF986

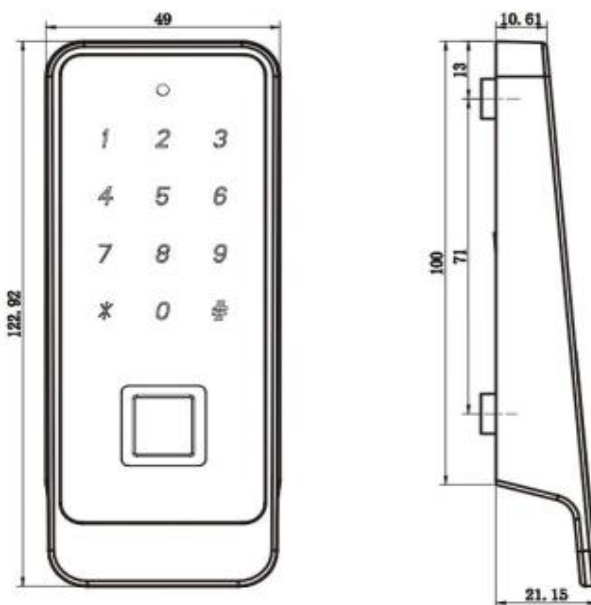

IF986 Dimension

5,Introduction of Real plate

Any of our front panels can match with below rear panel :

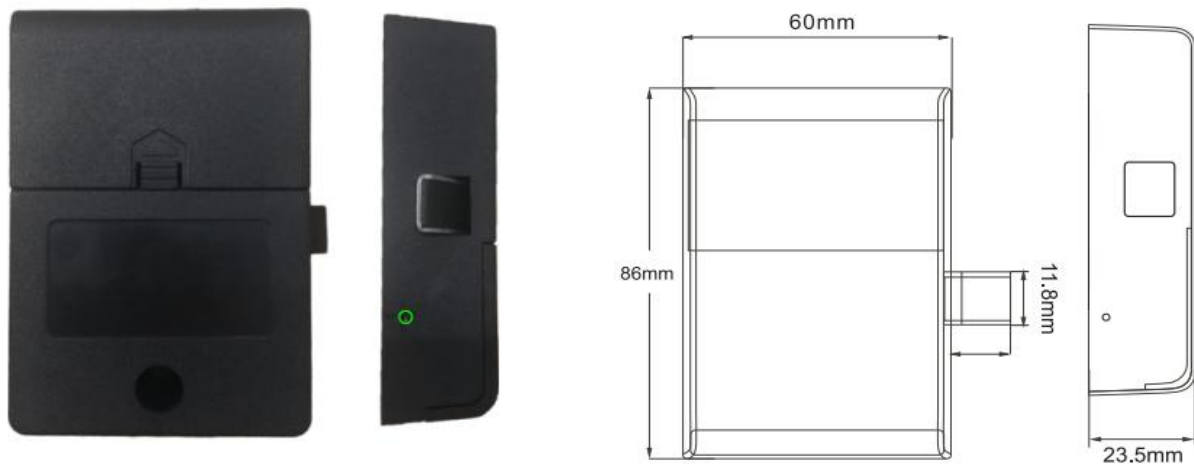

Latch mechanism operation reaches at least 250,000 times; mortar rotation operation reaches over 350,000 times.



Powered by 3 pcs AAA batteries, the span life is around 1 year.

5.1 FPC fingerprint sensor

360 ° finger
intelligent
recognition, more
using and more
sensitive.



5.2 The Morto in the 3rd Generation Rear Panel

Mabuchi Motor

Reliable and rest

Powerful and Silent

Mabuchi Motor, powerful and strong, you can hear smooth operation sound when unlocking, it is from Mabuchi Motor.

2000 Rpm | **26dB**
High speed | **Super silence**



Motor is the heart of the lock, Ilockey adopts Japan MABUCHI micro-motors which ensure 350,000 running times without problem, the malfunction rate is far less than 1/10000.

5.3 PCBA Quality Control:

If Motor is the heart of the lock, chip should be the brain of the lock, with the latest model of Philip chipset, the lock rate increase 30% of performance. The malfunction rate is far less than 1/1000. At mean time, It past the CE and FCC test.

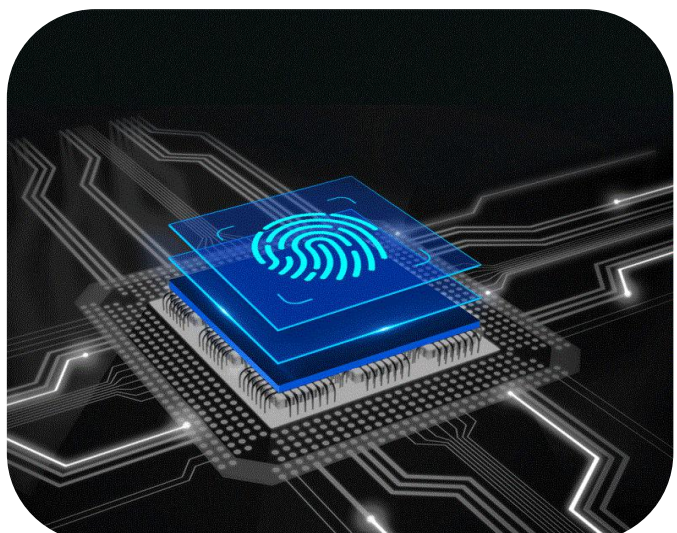

5.4 Stainless steel latch



6,Project for Reference:



Government locker Lock project in Thailand Furniture Factory

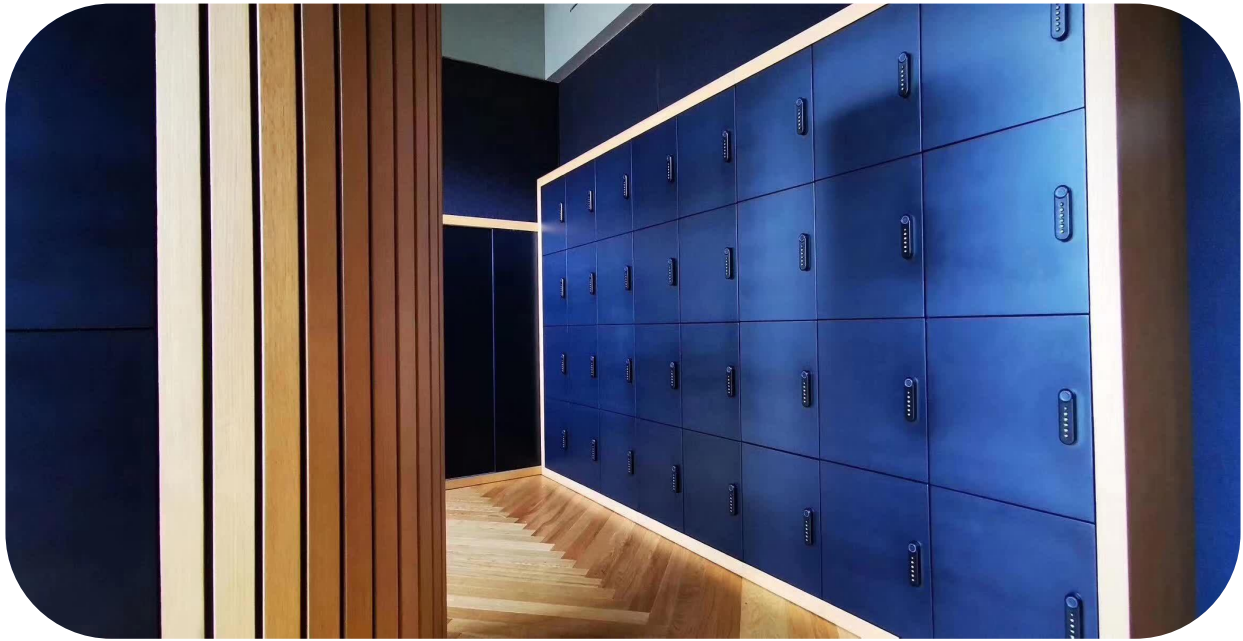

Sports Venues Lock project in Spain

7,How to operate the lock?

<https://www.youtube.com/watch?v=iEpTx-jXv44&feature=youtu.be>